

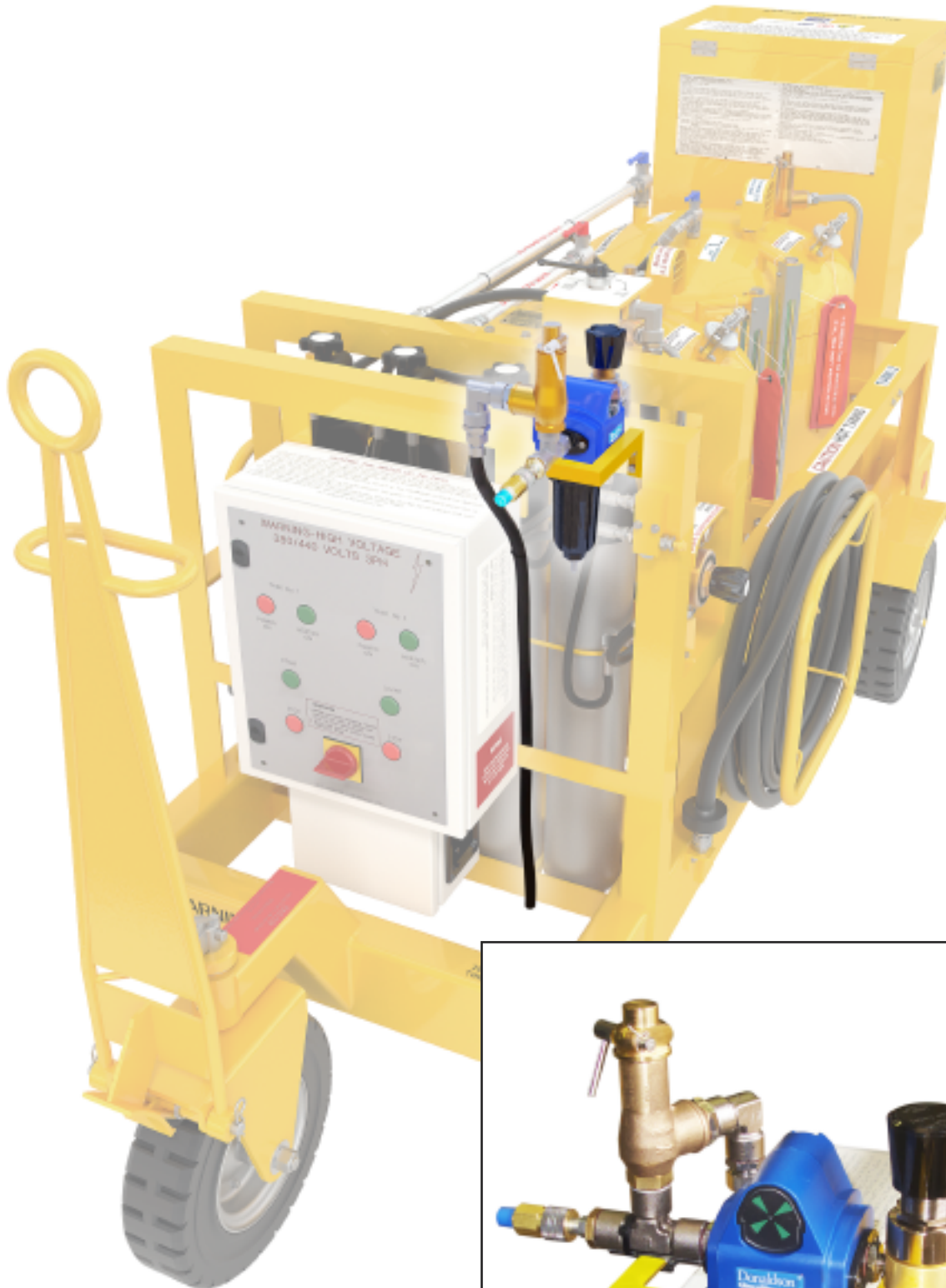

2x50 Gallon Wash Rig Accessory Air Inlet Kit (JMP/LUFT/D/6821)

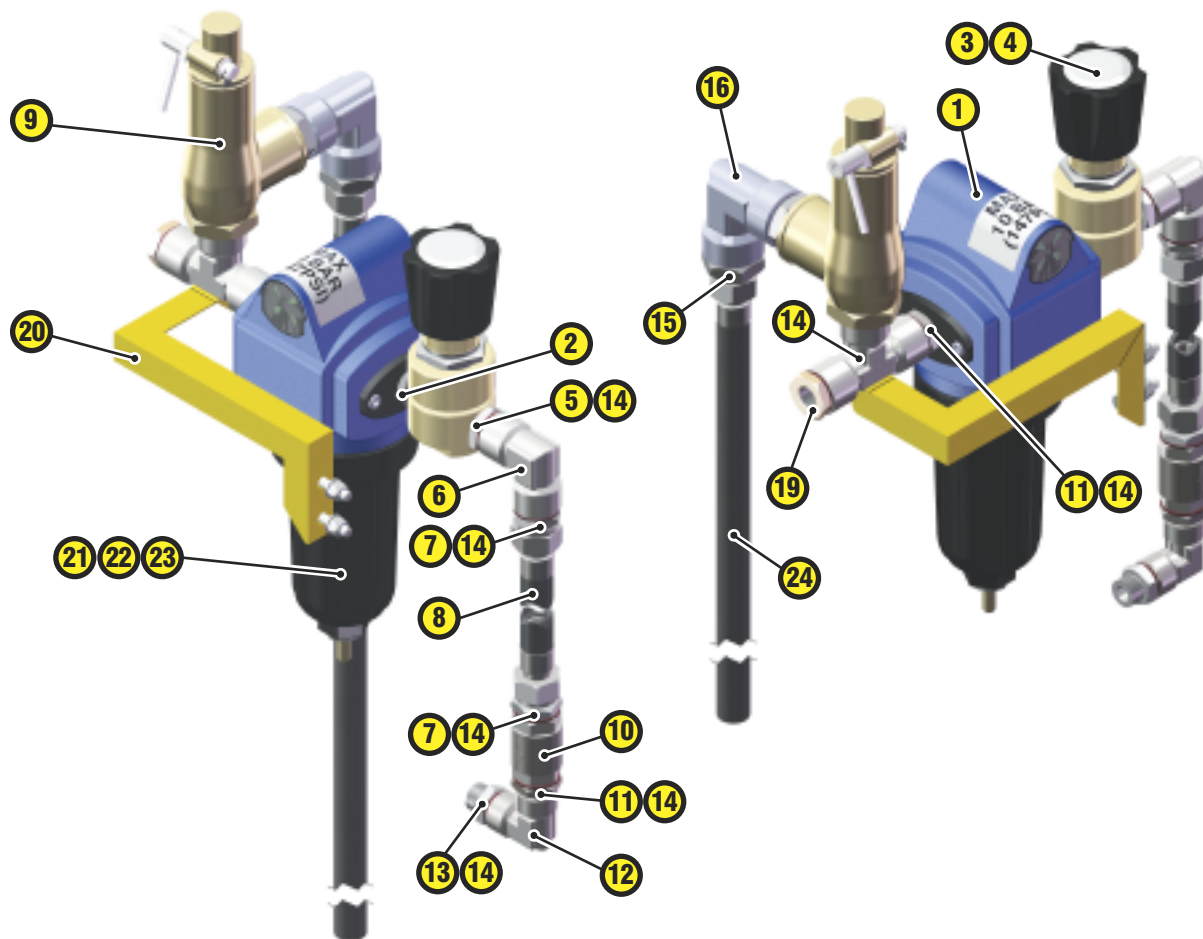



Item no.	Part no.	Description	Quantity
1	SM749	Donaldson filter	1
2	JMP/STD/A/1724	Adaptor, 3/8" BSP x 1/4" NPT	1
3	SM647/1	Nitrogen inlet regulator valve, 1/4" NPT ports	1
4	SM647/2	Regulator securing nut	1
5	JMP/APACHE/A/6220	Adaptor, 1/2" x 1/4" BSPT	1
6	SM052	Elbow, 1/2" BSP	1
7	JMP/STD/A/5289	Adaptor, 1/2" BSP x 1/2" BSP	2
8	JMP/RGT/HL/6827	Hose assembly, 1/2" NB x 56" (1422mm)	1
9	SM950	Safety relief valve, 150psi metal seats	1
10	SM050	Non-return valve	1
11	JMP/STD/A/5353	Adaptor, 1/2" BSP x 3/8" BSP	2
12	SM058	Equal elbow, 3/8" BSP	1
13	JMP/STD/A/5141	Adaptor, 3/8" BSP	1
14	As supplied	Various fibre washers	1
15	JMP/PEG/A/0298	Adaptor, 3/4" BSP x 1/2" BSP	1
16	SM054	Elbow, 3/4" BSP	1
17	JMP/STD/A/5349	Adaptor	1
18	SM053	Equal tee, 1/2" BSP	1
19	JMP/STD/A/4790	Adaptor, 1/2" BSP (m) x 1/4" BSP (f)	1
20	JMP/RR/D/6821/3	Support bracket	1
21	As supplied	Washer, M6	4
22	As supplied	Hex head bolt, M6 x 25mm long	2
23	As supplied	Nyloc nut, M6	2
24	JMP/RR/D/6821/4	Outlet hose	1