

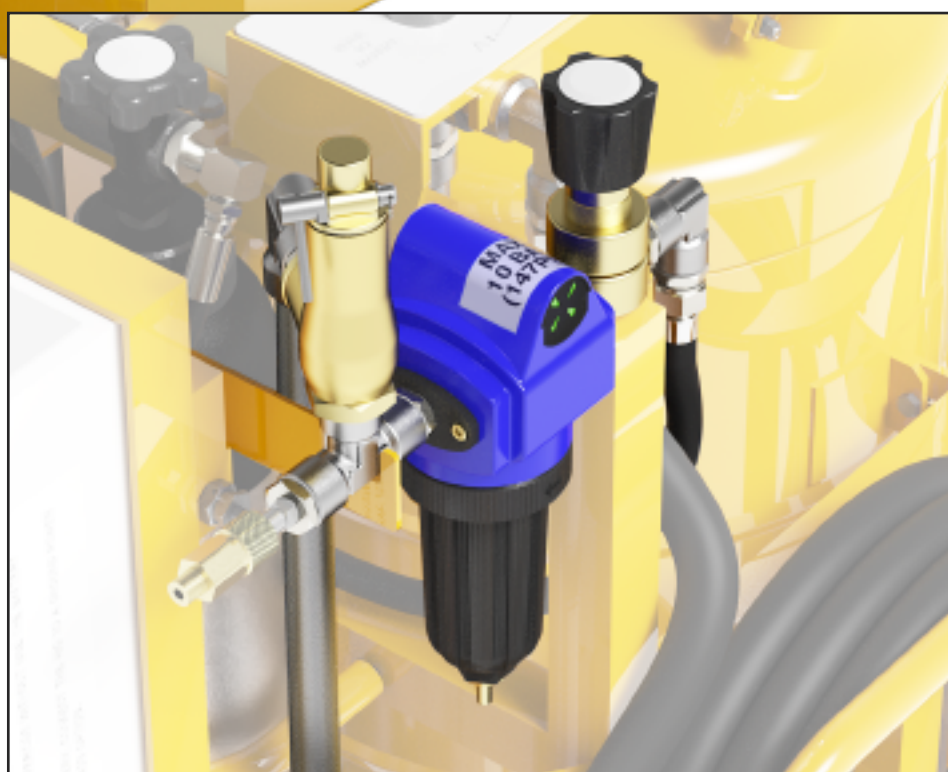

2x25 Wash Rig Accessory Air Inlet Kit JMP/CFM56/D/6612

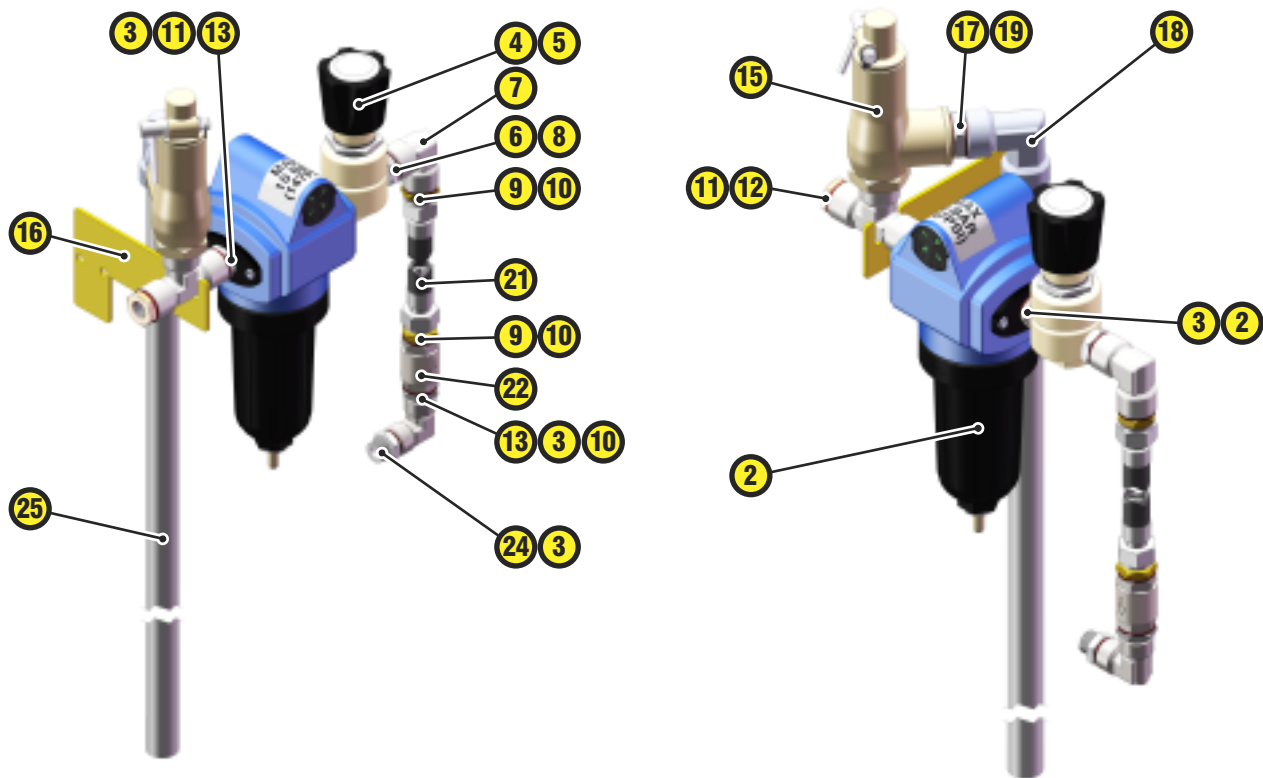



Item no.	Part no.	Description	Quantity
1	SM749	Donaldson filter	1
2	JMP/STD/A/5352	Adaptor, 3/8" BSP x 1/4" BSP	1
3	As supplied	Fibre washer, 16mm I/D x 2mm thick	4
4	SM647/1	Nitrogen inlet regulator valve, 1/4" NPT ports	1
5	SM647/2	Regulator securing nuts	1
6	JMP/STD/A/1686	Adaptor, 1/2" BSP x 1/4" BSP	1
7	SM052	Elbow, 1/2" BSP	1
8	As supplied	Fibre washer, 22mm I/D x 1.5mm thick	1
9	JMP/STD/A/5289	Adaptor, 1/2" BSP x 1/2" BSP	2
10	As supplied	Fibre washer, 21mm I/D x 1.5mm thick	3
11	As supplied	Fibre washer, 19.4mm I/D x 1.5mm thick	3
12	JMP/STD/A/4790	Adaptor, 1/2" BSP (m) x 1/4" BSP (f)	1
13	JMP/STD/A/5353	Adaptor, 1/2" BSP x 3/8" BSP	2
14	SM053	Equal tee, 1/2" BSP	1
15	SM950	Safety relief valve, 150psi metal seats	1
16	JMP/CFM56/A/7082	Safety valve support	1
17	JMP/STD/A/5349	Adaptor	1
18	SM054	Elbow, 3/4" BSP	1
19	As supplied	Fibre washer, 26mm I/D x 1.5mm thick	2
20	As supplied	Warning label, Max 147psi	1
21	JMP/RGT/HL/6827	Hose assembly, 1/2" x 56" (1422mm)	1
22	SM050	Non-return valve	1
23	SM058	Equal elbow, 3/8" BSP	1
24	JMP/STD/A/5141	Adaptor, 3/8" BSP	1
25	JMP/CFM56/D/6612/01	Blow-off tube assembly	1

14/07/16



AIRCRAFT SERVICE EQUIPMENT

A.T.Juniper (Liverpool) Limited.
Marshall Works,
5-17 Bleasdale Road, Allerton,
Liverpool L18 5JB

Tel: +44(0)151 733 1553
or +44(0)151 609 0428

Also at:
Ash House, Prenton Way,
North Cheshire Trading Estate,
Prenton, Wirral CH43 3DU

Email: gse@juniper-liverpool.com
Web: www.juniper-liverpool.com

Contractors to
H.M. Government Departments
Approved to ISO 9001:2015